

Super-Bond Brush-dip



DIRECT BONDED BRIDGE

KEY POINTS FOR THE BRUSH-DIP TECHNIQUE

- ① The activated liquid (mixture of Monomer and Initiator) decomposes gradually and loses activity. Use it within 5 min after preparation.
- ② Pre-wetting the surface with the activated liquid is essential to assure maximum cement adaptation and to create the highest possible bond strength.
- ③ Soak the brush with ample activated liquid. It makes a ball of powder form easier.
- ④ When you dip the brush into the powder, making a small circle with the Brush Tip, touch the surface of the Polymer powder to pick up a small ball of powder.
- ⑤ After each application, use a piece of gauze to clean the resin off the brush tip before dipping it into the liquid again.

PRETREATMENT OF THE TOOTH SURFACE

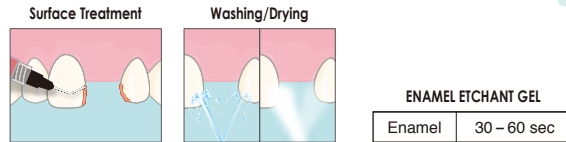

MIXING RATIO

Brush-dip Monomer	Brush-dip Initiator
4 drops	1 drop
8 drops	2 drops

CURING TIME in Brush-dip Technique

Polymer	Brush-dip Monomer
Brush-dip Clear	5 min

*See the Instructions to use

BRUSH-DIP TECHNIQUE

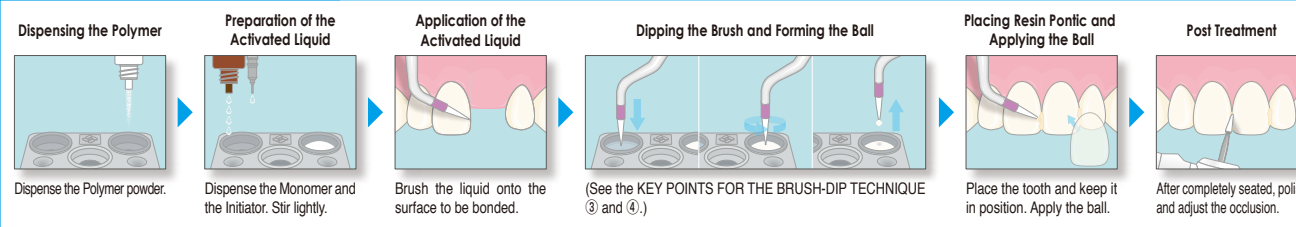

Super-Bond Brush-dip



FIXATION OF A MOBILE TOOTH

KEY POINTS FOR THE BRUSH-DIP TECHNIQUE

- ① The activated liquid (mixture of Monomer and Initiator) decomposes gradually and loses activity. Use it within 5 min after preparation.
- ② Pre-wetting the surface with the activated liquid is essential to assure maximum cement adaptation and to create the highest possible bond strength.
- ③ Soak the brush with ample activated liquid. It makes a ball of powder form easier.
- ④ When you dip the brush into the powder, making a small circle with the Brush Tip, touch the surface of the Polymer powder to pick up a small ball of powder.
- ⑤ After each application, use a piece of gauze to clean the resin off the brush tip before dipping it into the liquid again.

PRETREATMENT OF THE TOOTH SURFACE



MIXING RATIO

Brush-dip Monomer	Brush-dip Initiator
4 drops	1 drop
8 drops	2 drops

CURING TIME in Brush-dip Technique

Polymer	Brush-dip Monomer
Brush-dip Clear	5 min

*See the Instructions to use

BRUSH-DIP TECHNIQUE

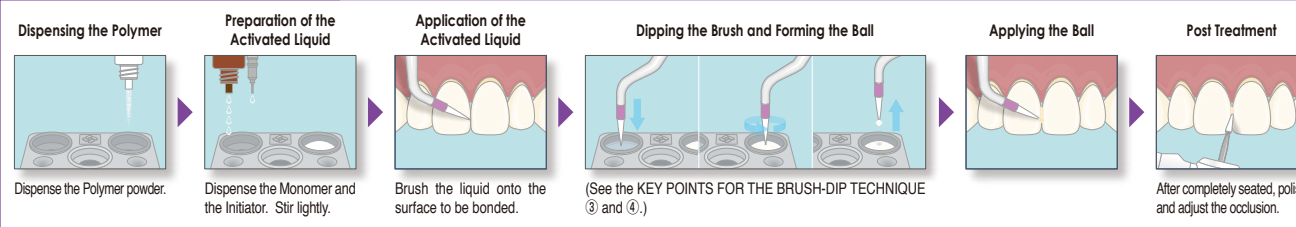

J027M/1A